

OPERATING INSTRUCTIONS

ADE

Plate Tower Systems



Plate Tower Systems – TM Tabletop Series

TM-210420-Rev005-UM-en



1. CONTENTS

1.	CONTENTS	2
2.	FOREWORD	3
3.	START-UP.....	3
	Assembling Tabletop Plate Towers	3
	Tabletop Plate Tower Assembly Drawing	4
	Adjusting the Plate Holders to Different Plate Sizes	4
	Refitting with Wheel Set (Optional)	4
	Using the Wall Mounting Device (Optional)	5
	Tabletop Plate Tower Wall Mounting Device Assembly Drawing	5
4.	CLEANING AND CARE	6
5.	TECHNICAL DATA	6
6.	EXPLODED VIEWS	7
	Columns for All TM Models	7
	Spare parts list	7
	TM Exploded View	8
	TM Spare Parts List	8
	Wall Mounting Device Exploded View	9
	Wall Mounting Device Spare Parts List.....	9

2. FOREWORD



This symbol means: “Observe operating instructions.” Read these operating instructions carefully and observe the information contained therein. Keep these operating instructions handy for future reference.

The TM series tabletop plate towers offer flexibility, versatility, and reliability and have been specially developed for all types of commercial kitchens with limited space for preparing and serving meals.

Plates arranged for preparation and serving take up a lot of space in the kitchen or cold room. The plate towers enable efficient use of the available workspace. The TM series allows stacking a maximum of 48 plates up to 33 cm in diameter and 5 cm high within a minimal space without disturbing the arrangement of dishes on the plates. Another application involves, for example, serving platters with salads, desserts, or cakes at a buffet. The TM series can accommodate all kinds of plates: large and small, thick and thin, even bowls with a raised rim. It does not matter whether they are round, oval, or square.

The adjustment requires no special tools; simply set the adjusting screw by hand.

The requirements vary depending on the application or kitchen. The TM series, therefore, offers space for 12 to 48 plates in various sizes.

The base and column are made of aluminum and plastic.

The TM series plate towers can optionally be supplied with a wheel set, which enables the towers to be moved, as well as a wall mounting device.

Alternatively, the plate towers are also available as mobile plate trolleys (PM or PM-DUO series) and plate tower walls (WM series) of various sizes.

3. START-UP

The TM series tabletop plate towers come in different sizes to accommodate varying plate numbers: TM12 for up to 12 plates, TM24 for up to 24 plates, TM36 for up to 36 plates, and TM48 for up to 48 plates.

Assembling Tabletop Plate Towers

The tabletop models are delivered mostly pre-assembled in cardboard boxes. All you need to do is attach the base underneath.

Remove all parts from the box and lay them out ready. Remove the two square tubes with the adjustable feet (56) from the mounting block (13) and press the tubes into their respective recesses crosswise at 90°, i.e., the longer tube into the upper recess and the shorter tube into the lower recess. Press firmly.

Take the threaded rod (33), spacer sleeve (57), and M10 nut (not self-locking) and tighten the nut until it is about 10 cm from the bottom edge of the rod.

Push the spacer sleeve from the bottom edge against the nut. Insert the threaded rod through the two holes in the square tubes and the fixing block (58) until the spacer sleeve rests on the upper tube.

Then, fit the self-locking nut (16) with the washer (15) to the lower end of the threaded rod. With the nut tightened, the threaded rod must not protrude more than a few millimeters from the nut. Using pliers, you can hold the threaded rod in the middle to prevent it from turning when tightening the self-locking nut.

Tighten the nut (34) firmly above the spacer sleeve. The base is now fixed in place.

Place the fixing block (58) over the threaded end. The spacer sleeve fits through the hole in the base. Now push the column over the upper threaded end and attach the top cap (2) to the top of the column using the four adjusting screws (1). Then, attach the suspension lug (31) and fit the two pieces of the handle (50) through the lug. The tabletop plate tower is now ready for use.

You can fix or rotate the column using the handle and the suspension lug.

Tabletop Plate Tower Assembly Drawing

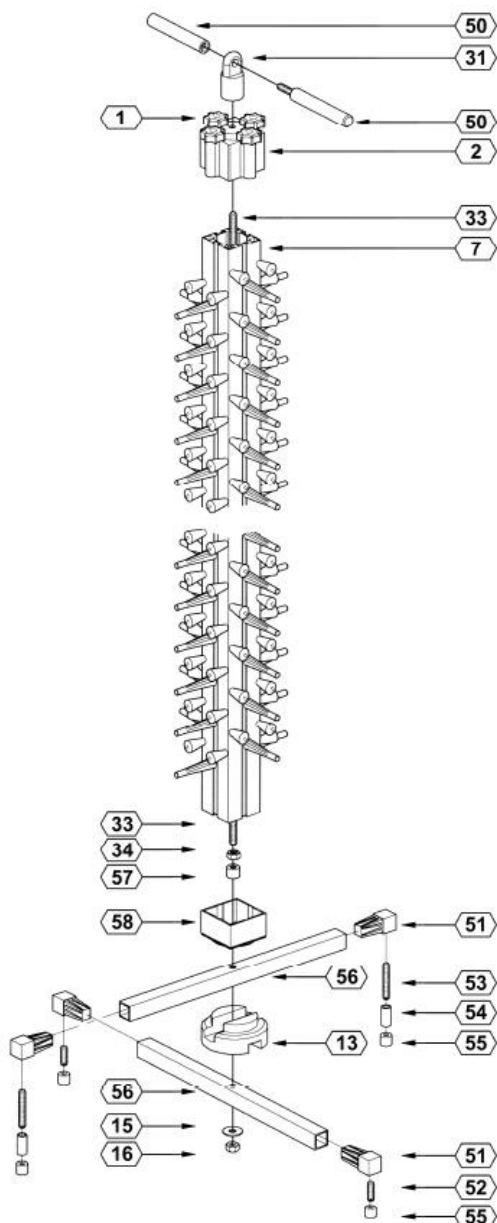

Adjusting the Plate Holders to Different Plate Sizes

Each of the four column sides can individually be adjusted to different plates of up to 33 cm in diameter and 5 cm in height.

Use the adjusting screws to change the height of the black plate holders.

Turning the adjusting screw to the right reduces the gap between the red and black plate holders, allowing shallower plates to be stacked.

Accordingly, you can stack taller plates by turning the adjusting screw to the left to increase the gap between the black and red plate holders.

Refitting with Wheel Set (Optional)

The TM series plate towers can optionally be supplied with a wheel set. The wheel set adds mobility to the tabletop towers. The wheel set consists of two larger and two smaller casters. Each caster fits into the square tubes of the base frame instead of the foot plug.

Tighten the caster firmly using a 13 mm wrench (not included).

Using the Wall Mounting Device (Optional)

Each tabletop plate tower can be converted into a wall-mounted plate tower. The optional stainless steel wall mounting device allows the plate tower to be mounted on the wall.

One wall mounting device is generally enough for the TM12 and TM24 plate towers, whereas the TM36 and TM48 plate towers require two such devices.

You will also need a wall strong enough to support the device with the plate tower and suitable fasteners (not included). The design enables quick attachment and removal of the plate tower. You can remove the base when using the appliance as a converted wall-mounted plate tower.

Tabletop Plate Tower Wall Mounting Device Assembly Drawing

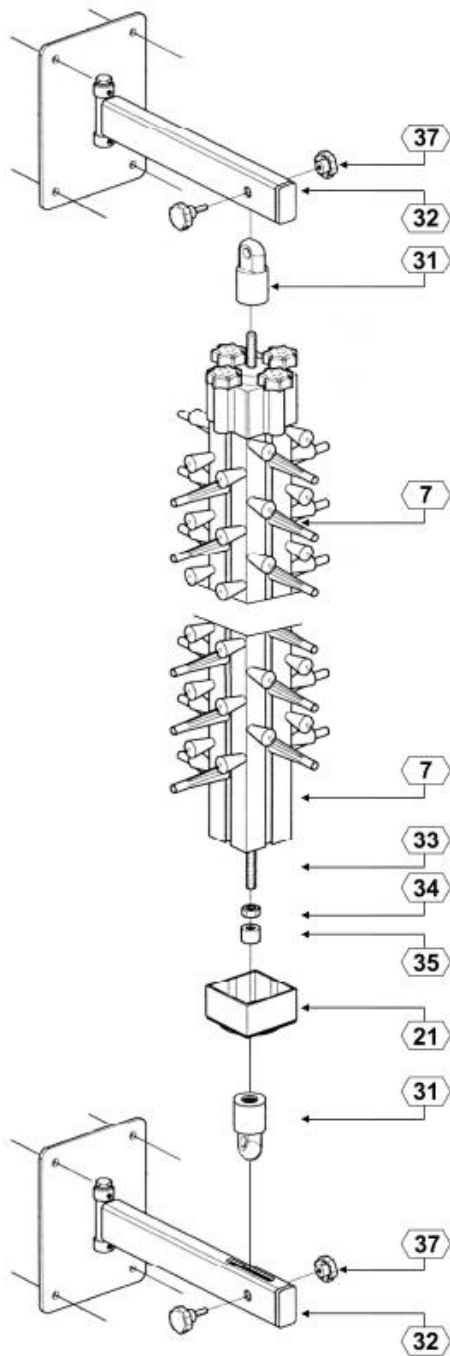

4. CLEANING AND CARE

The TM series plate towers require no user maintenance.

The plate towers must be cleaned regularly with warm water and commercially available cleaning agents. High-pressure cleaning is allowed.

Should you have any problems or require spare parts for the plate tower, contact the dealer from whom you purchased the product.

5. TECHNICAL DATA

Model	TM12	TM24	TM36	TM48
Plates	12	24	36	48
Plate diameter/height	330 mm/50 mm	330 mm/50 mm	330 mm/50 mm	330 mm/50 mm
Height	490 mm	730 mm	930 mm	1140 mm
Footprint	360 x 360 mm	360 x 360 mm	360 x 360 mm	360 x 360 mm
Net/gross weight	2.5 kg/3 kg	3.9 kg/4.6 kg	5.2 kg/6 kg	6.4 kg/7.3 kg
Package dimensions	600 x 200 x 200 mm	740 x 200 x 200 mm	850 x 200 x 200 mm	1250 x 200 x 200 mm

Optional:

Wall mounting device set LM for models TM12 and TM24 (item no. Z4636).

Wall mounting device set LM for models TM36 and TM48, two items needed (item no. Z4636).

Wheel set WH for tabletop models TM12, TM24, TM36, and TM48 (item no. Z4638).

6. EXPLODED VIEWS

Columns for All TM Models

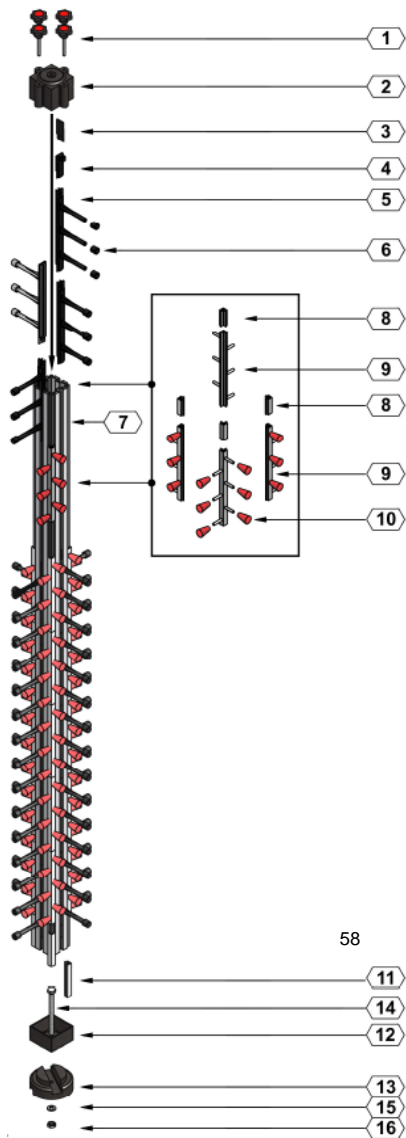

Spare parts list

Position	Designation	Item no.
1	Adjusting screw M6x60	H4630-008
2	Top cap	H4630-003
3	Extension	H4630-007
4	Pulley	H4630-006
5	Support set, three fingers	H4630-004
6	Rubber cap, black	H4630-002
7	Main column guide, aluminum	
8	Corner extension, gray, 44 mm	
9a	Corner support, gray, right (marked R)	H4630-013
9b	Corner support, gray, left (marked L)	H4630-0131
10	Rubber cap, red	H4630-009
11	Corner extension, gray, 95 mm	
13	Nylon mounting block	H4630-018
14	Connecting screw M10x40 mm	
15	Washer 30x10 mm	
16	Self-locking nut M10	
58	Plastic base for column, 21.5 mm hole	

TM Exploded View

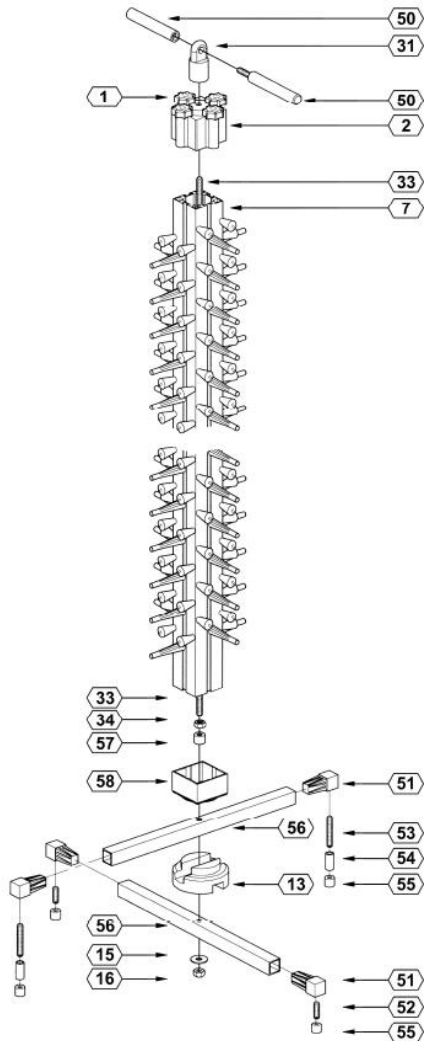

TM Spare Parts List

Position	Designation	Item no.
1	Adjusting screw M6x60	H4630-008
2	Top cap	H4630-003
7a	Aluminum column TM12, 355 mm long	
7b	Aluminum column TM24, 570 mm long	
7c	Aluminum column TM36, 775 mm long	
7d	Aluminum column TM48, 985 mm long	
13	Nylon mounting block	H4630-018
15	Washer 30x10 mm	
16	Self-locking nut M10	
31	Suspension lug	
33	Threaded rod	
34	Nut M10	
50	Plastic handle	
51	Foot plug	H4630-023
52	Base adjusting screw, 30 mm	H4630-024
53	Base adjusting screw, 60 mm	H4630-025
54	Base spacer sleeve	H4630-026
55	Base rubber cap	H4630-027
56	Base frame square tubes	
57	Column spacer sleeve M10	
58	Fixing block, 21.5 mm hole	H4630-011

Wall Mounting Device Exploded View

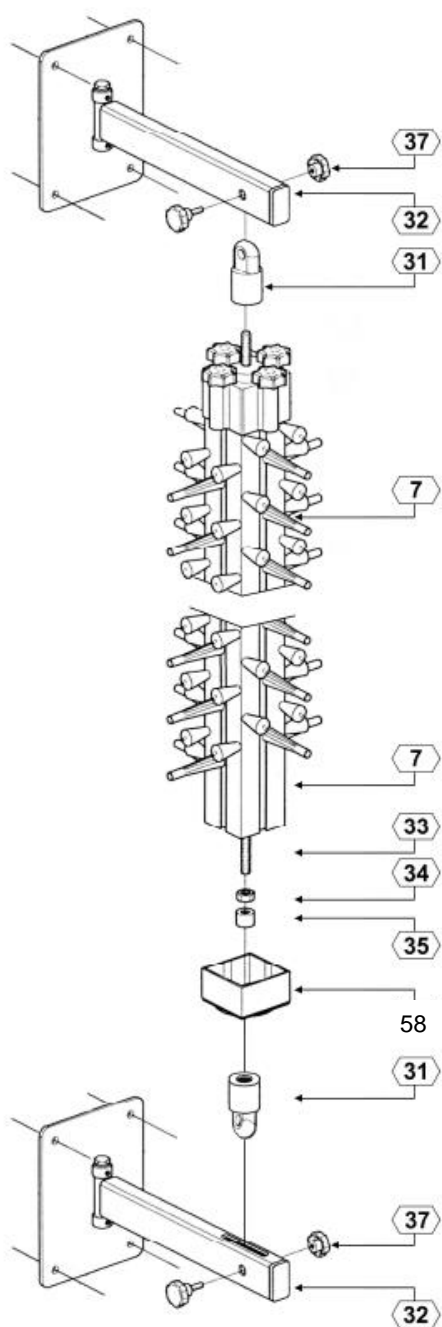

Wall Mounting Device Spare Parts List

Position	Designation	Item no.
32	Wall mounting device stainless steel arm	
37	Wall mounting device locking screw	

Distributor:

Manufacturer:

ADE Germany GmbH
Neuer Höltigbaum 15
22143 Hamburg

 +49 40 432 776 - 0

 +49 40 432 776 - 10

 info@ade-germany.de

 www.ade-germany.de