

Labelling scale

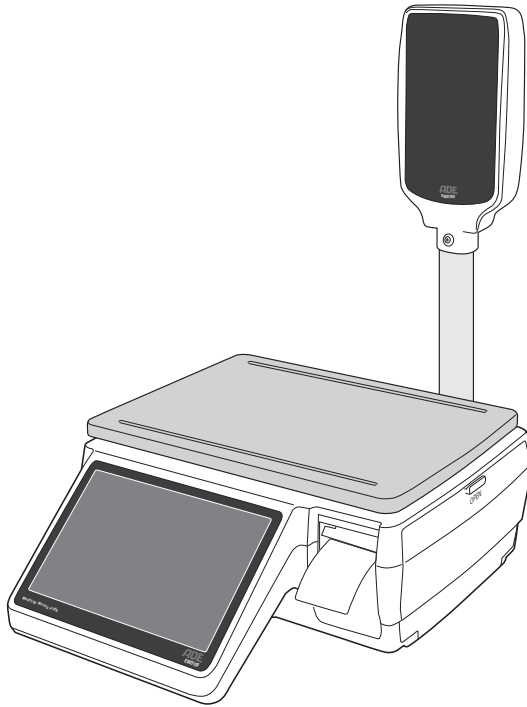

SERIES EWD100 6 kg/15 kg

User manual



Table of contents

Package contents	3
General information	4
Reading and storing the user manual	4
Proper use.....	4
Explanation of symbols	4
Safety	6
Explanation of notes	6
General safety instructions	6
Description of the device	11
First use	13
Checking the scale and package contents.....	13
Setting up the scale.....	13
Mounting the tripod display	14
Aligning the scale	14
Inserting/replacing the label roll in cassette.....	14
Mains connection.....	15
Switching on and off	15
Connecting the scale to a network	16
Connecting the scale to the computer.....	21
Carrying out the basic configuration using PC software	22
Creating categories and products	25
Exporting data to the scale	33
Changing the price	34
Operation	36
Login.....	36
Weighing items	37
Setting Auto label.....	37
Using the tare function	38
Label formats	39
Troubleshooting	43
Cleaning and maintenance	44
Transport	45
Storage	45
Spare parts	45
Technical specifications	45
Disposal	46
Disposing of the packaging	46
Disposing of the appliance.....	46
Declaration of Conformity	46
Warranty	47

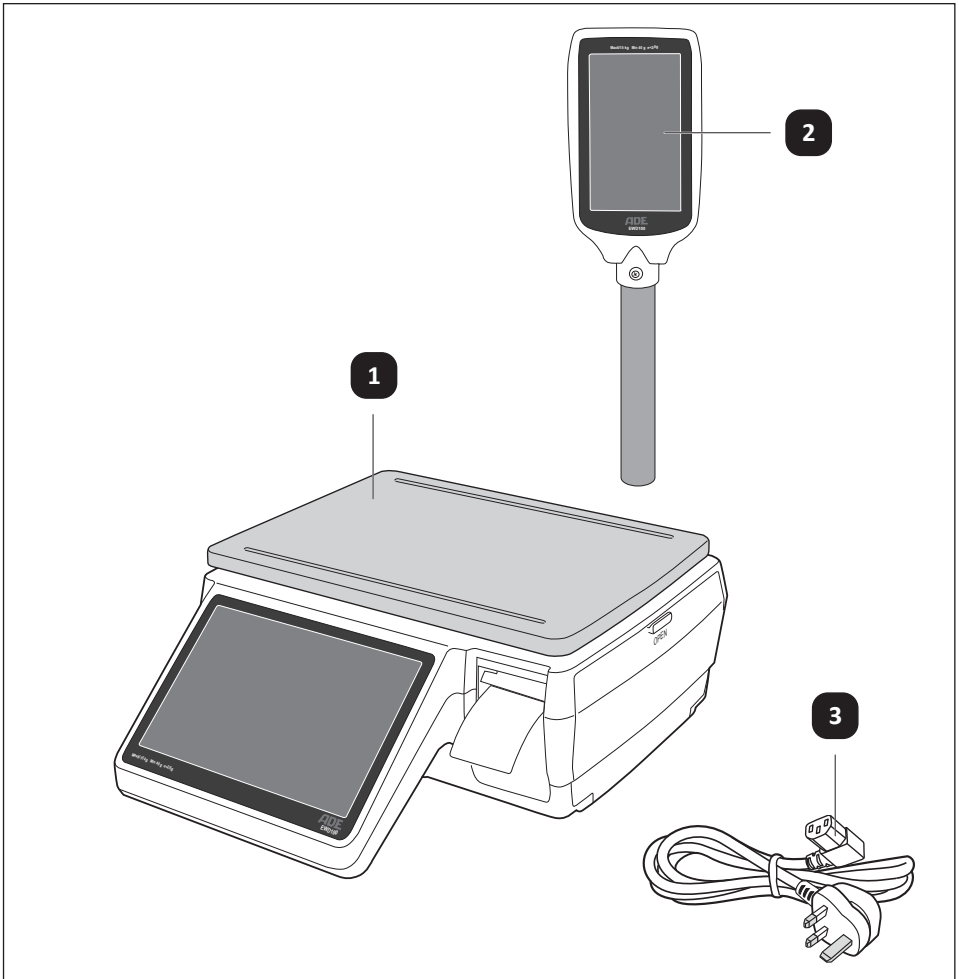

Package contents

- | | | | |
|----------|---|----------|--|
| 1 | Scale (with detachable weighing platform) | 3 | Mains cord |
| 2 | Tripod display | 4 | Declaration of Conformity and User Manual (without illustration) |

Required tools (not included in the package contents)

- | | |
|----------|---------------------|
| 5 | Slotted screwdriver |
|----------|---------------------|

General information

Reading and storing the user manual



This user manual is part of this labelling scale (hereinafter referred to only as 'scale'). It contains important information on start-up and handling.

Read the user manual carefully, especially the safety instructions, before you begin using the scale. Failure to heed this user manual may cause severe injury or damage to the appliance.

The user manual is based on the standards and rules in force in the in the European Union and United Kingdom.. When abroad, you must also observe country-specific guidelines and laws.

Store the user manual for future use. Should you give the scale to another person, it is vital that you also pass on this user manual.

Proper use

The scale is designed solely for weighing items. It is intended for commercial use only.

The scale is intended for use as a non-automatic scale. This means that items to be weighed must be manually placed in the centre of the weighing platform. The reading can be taken once the weight value has stabilised.

Only use the scale as described in this user manual. Any other use is deemed improper and may result in damage to property or even personal injury. The manufacturer or vendor accepts no liability for damage caused by improper or incorrect use.

Explanation of symbols

The following symbols can be found in this user manual, on the appliance or on the packaging.



This symbol provides you with useful supplementary information on setup and handling.



Read and observe the user manual. This symbol indicates that the user must read the user manual before the first use of the appliance.



CE symbol with year of affixing (see chapter "Declaration of Conformity")



Declaration of Conformity (see chapter "Declaration of conformity"): Products labelled with this symbol meet all applicable provisions of the United Kingdom.

0122

Official number of the “Notified Body” of the initial calibration



Accuracy class of the scale (commercial scale)

e=

Calibration value (scale interval)



Direct current



Alternating current

d=

Digit increment

IP20

The scale has the degree of protection “IP20”. It is protected against solid foreign objects with a diameter of ≥ 12.5 mm and is only intended for indoor use.



Appliances marked with this symbol are designed for indoor use only.



The “Safety Tested” seal confirms that an appliance marked with this symbol is safe if used as foreseeable. The test seal confirms conformity with the German Product Safety Act.



This symbol identifies devices that belong to the protection class II.

Safety

Explanation of notes

The following symbols and signal words can be found in this user manual, on the appliance or on the packaging.



WARNING!

This signal symbol/word designates a hazard with a moderate degree of risk which may lead to death or severe injury if not avoided.



CAUTION!

This signal symbol/word designates a hazard with a low degree of risk which may lead to minor or moderate injury if not avoided.



NOTICE!

This signal word warns against potential damage to property.

General safety instructions



WARNING!

Risk of electric shock!

Faulty electrical installation, excessive mains voltage or improper handling may result in electric shock.

- Only plug the scale into the power outlet if the mains voltage corresponds to the data on the rating plate.
- The power outlet the scale is to be plugged into should be easily accessible so that the scale can be quickly unplugged in the event of a fault.
- Do not operate the scale if it has visible damage or if the mains cord is defective.
- Do not operate the scale if it has been exposed to humid storage conditions for a long time.
- If the mains cord is damaged, it must be replaced by the manufacturer, the manufacturer's after-sales support or a person with similar qualifications to avoid risks.

- Do not open the housing; instead, have a qualified professional carry out repairs. Contact a qualified workshop for this.
- Only parts that comply with the original device specifications may be used for repairs. This scale contains electrical and mechanical parts that are essential for protection against hazards.
- Do not carry out any independent repair work or modifications to the scale or the mains cord. This can affect the operational safety of the scale. Independently performed repairs, installation of spare parts not supplied by the manufacturer, improper connection or operation of the scale will render the warranty null and void.
- Do not immerse the scale, the power cord or mains plug in water or other liquids.
- Never touch the mains plug with damp hands.
- Never pull the mains plug out of the socket by the mains cord; instead, always do so by taking hold of the mains plug.
- Never use the mains cord as a carrying handle.
- Keep the scale and mains cord away from open flames and hot surfaces.
- Do not bend the mains cord or place it over sharp edges.
- Only use the scale indoors. Never use it in wet rooms or in the rain.
- Never store the scale such that it could fall into a bathtub or sink.
- Never reach to retrieve an electrical device if it has fallen in water. In such a case, immediately disconnect the mains plug from the socket.
- Ensure that children do not insert objects into the scale.
- When you are not using the scale, cleaning it, maintaining it, replacing parts or when a malfunction occurs, always switch off the scale and disconnect the mains plug from the socket. Place the unplugged mains plug where it can be seen at all times so that you can make sure that the scale is disconnected from the mains.



WARNING!

Danger for children and persons with impaired physical, sensory or mental capacities (e.g. partially disabled persons, older persons with reduced physical and mental capacities) or lack of experience and knowledge (e.g. older children).

- The scale can be used by children 8 years of age and above and by persons with reduced physical, sensory or mental capabilities or lack of experience and knowledge if they have been given supervision or instruction concerning the use of the scale in a safe way and if they understand the hazards involved. Children are not allowed to play with the scale. Cleaning and user maintenance must not be performed by unsupervised children.
- Keep children under 8 years of age away from the scale and connecting cable.
- Children shall not play with the scale.
- Do not leave the scale unattended while in operation.
- Do not let children play with the packaging wrapper. They may get caught in it when playing and suffocate.



CAUTION!

Risk of injury!

Improper handling of the appliance may cause injury.

- Only use the scale when it is fully and correctly assembled.
- Only use the supplied accessories.
- Never use the scale near highly flammable or explosive substances.
- Lay the power cord so that it does not pose a tripping hazard.
- Lay the power cord so that it does not pose a strangulation hazard.



CAUTION!

Health hazard!

Poor hygiene when handling the scale can seriously affect health.

- Clean the scale thoroughly of production residues before you begin using it.
- Do not place food without a tray or food that leaves residues (e.g. sausage or cheese) directly on the weighing platform. Always use a container or wrapping film, for example.
- Clean the weighing platform regularly.



NOTICE!

Risk of damage!

Improper handling of the scale may result in damage to the scale.

- Only use approved accessories and peripherals.
- Handle the scale with due care. Note that the scale is a precision instrument.
- Make sure not to break the seal on the bottom of the scale to avoid damaging the calibration.
- Observe the maximum weighing capacity of the scale. Do not exceed it.
- Do not expose the weighing platform to jolts and impacts.
- The scale must be operated as far away as possible from other equipment or sources of electromagnetic or other interferences (e.g. powerful motors or mobile HF communications equipment), as these can affect the measurement results.
- Only use the scale in dry indoor areas. It is not intended for outdoor use.
- Only use the scale within the permitted ambient conditions.

- Never place the scale near hot surfaces.
- Use the scale at constant ambient temperatures and avoid using it in draughty areas as this may yield incorrect measurement results.
- Ensure that the power cord does not come into contact with hot parts.
- Never expose the scale to high temperatures (e.g. heat, direct sunlight), moisture, humidity or external influences (e.g. rain).
- Never fill the scale with liquid.
- Never attempt to clean the scale by submerging it in water, and do not use a steam cleaner to clean it. The scale may otherwise get damaged.
- Do not put the scale in a dishwasher. It would be destroyed as a result.
- Discontinue use of the scale if its components have any cracks, flaws or deformations. Only replace damaged components with suitable original spare parts.
- Store the scale in a dry, cool place.

Description of the device

This platform scale **1** is designed exclusively for weighing items. The item to be weighed can be placed directly on the weighing platform **6** or weighed in a container, for example.

The scale prints labels for the identification of weighed items.

The scale can be connected to a computer. The PC software provided is used to set the product categories and products.

The scale is used in mains operation.

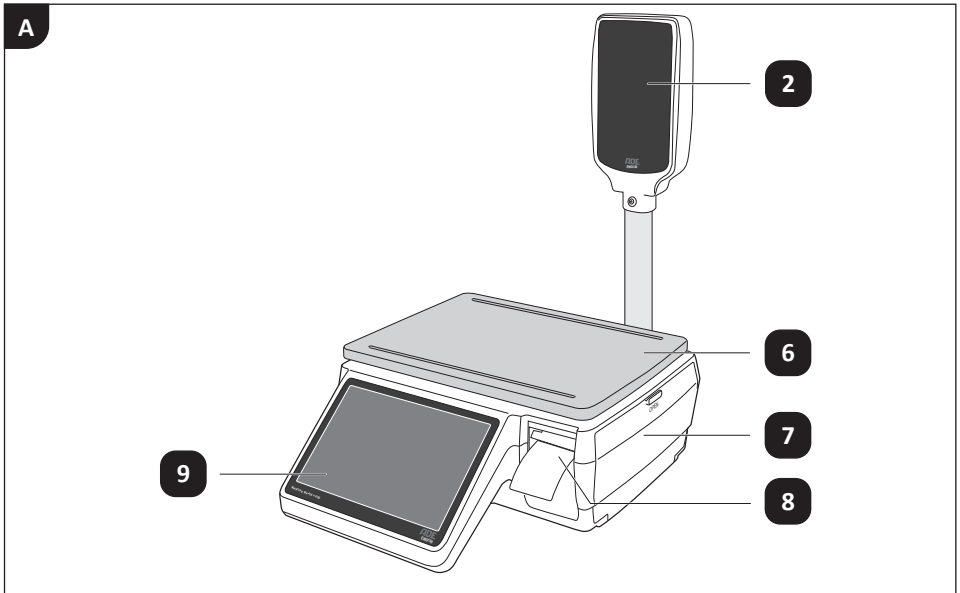

2 Tripod display

8 Label output

6 Weighing platform

9 Display

7 Cassette compartment flap

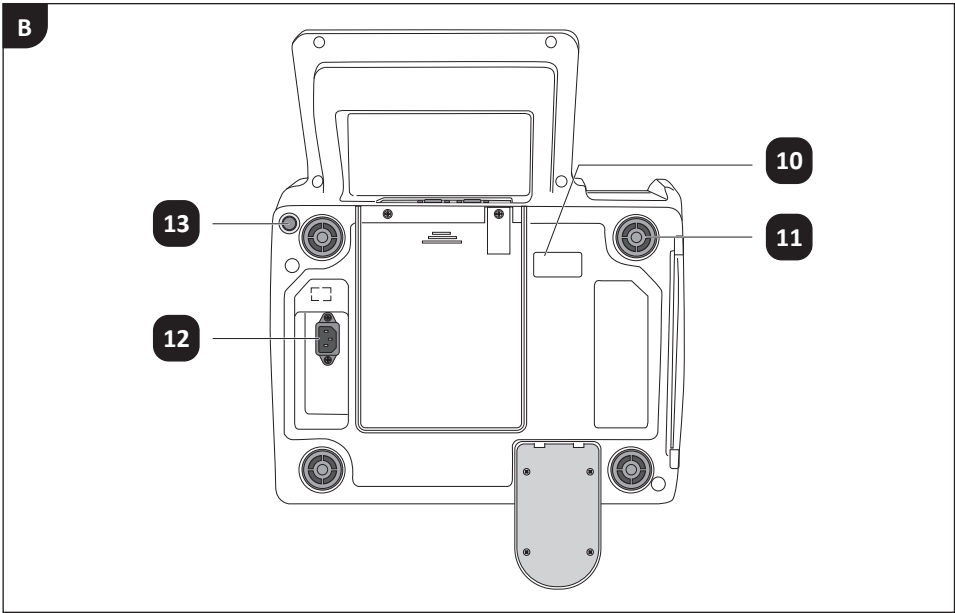

- 10 Sealing
- 11 Support foot, 4x
- 12 Mains cord connection
- 13 On/Off button

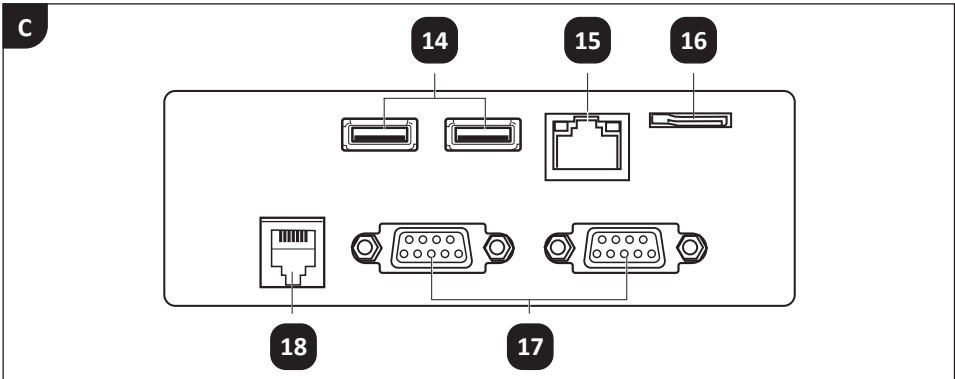

- 14 USB port, 2x
- 15 LAN port
- 16 SD card slot
- 17 Serial connection (RS232), 2x
- 18 Additional serial connection (RJ11)

First use

Checking the scale and package contents



Risk of damage!

If you are not cautious when opening the packaging with a sharp knife or other pointed objects, you may quickly damage the scale.

- Be very careful when opening the packaging.
 1. Remove the scale from the packaging.
 2. Check to make sure that all parts have been included in the delivery (see **Page 3**).
 3. Check whether the scale or the individual parts exhibit signs of damage. If this is the case, do not use the scale. Contact ADE Sales (see back page) or the dealer from whom the scale was purchased.
 4. Remove all packaging materials, protective films and labels attached to the appliance for transport protection or advertising purposes.



- Keep the original packaging and packaging materials for future transport of the scale.
- For calibrated scales: Check the identity of the serial numbers of the scale and the Declaration of Conformity. This is a necessary requirement for using the scale in legal metrology.
- Keep the Declaration of Conformity, as it will be needed for recalibration.
- Observe the notification obligation under Sec. 32 Para. 1 of the Measurement and Calibration Act (MessEG). Users can submit their notifications at www.eichamt.de.

Setting up the scale



Risk of damage!

The scale can get damaged due to overload.

- Do not place too much pressure on the scale.

Mounting the tripod display

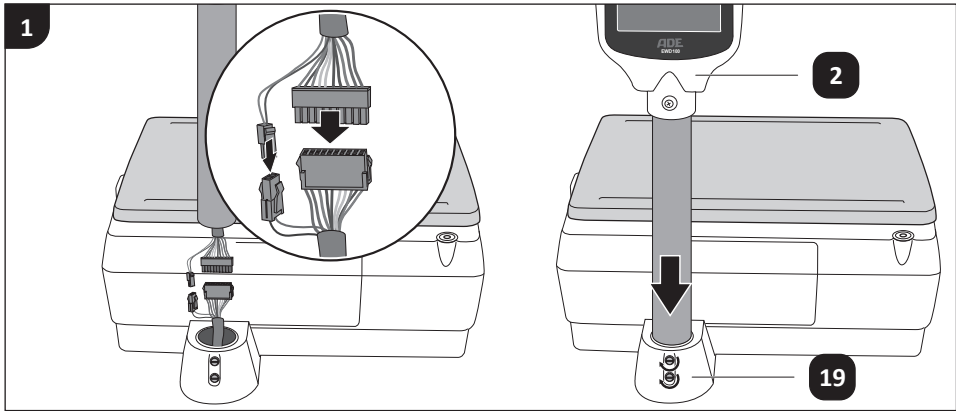

1. Connect the plug connections of the cables with each other. Pay attention to the colour polarity.
2. Place the cables in the stand of the tripod display **2**.
3. Place the tripod display in the holder **19** and fix it with the screws using a slotted screwdriver **5**.

Aligning the scale

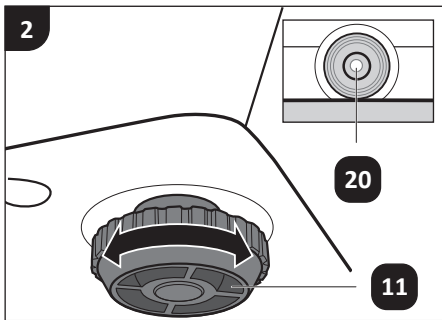

- Place the scale **1** on a level surface. Using the scale on a tilted surface can lead to incorrect measurement results.
- Level the scale using the built-in spirit level **20** by levelling it with the support feet **11**.

Inserting/replacing the label roll in cassette

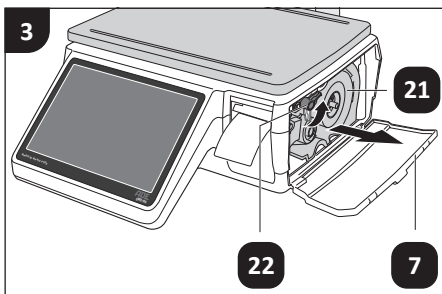

1. Open the cassette compartment flap **7**.
2. Turn the blue locking lever **22** upwards.
3. Remove the label cassette **21**.

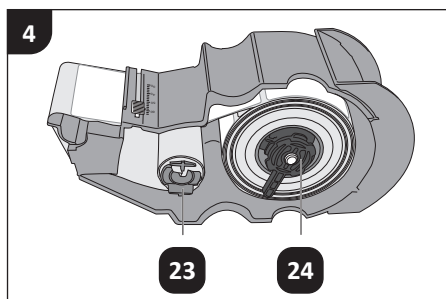

4. Pull off the roll holder **24**.
5. Insert a new roll by threading it into the tensioning device **23**.
6. If you want to change the roll, remove the empty roll by pulling it off the tensioning device.
7. Replace the roll holder.
8. Put the label cassette back in place.
9. Turn the blue locking lever downwards.
10. Close the flap of the cassette compartment.

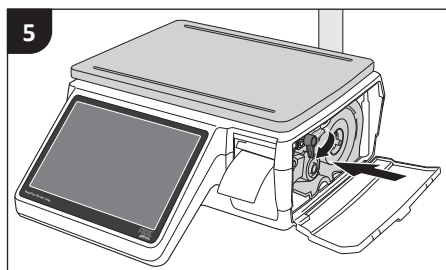

An additional label cassette can be reordered if different label sizes are used. See chapter "Spare parts" on Page 45.

Mains connection

1. Connect the mains cord **3** to the mains cord connection **12**.
2. Insert the mains plug in a properly installed earthed socket.
The scale switches on and pushes out a label.
3. Remove the label from the label dispenser.

Switching on and off

Switching on

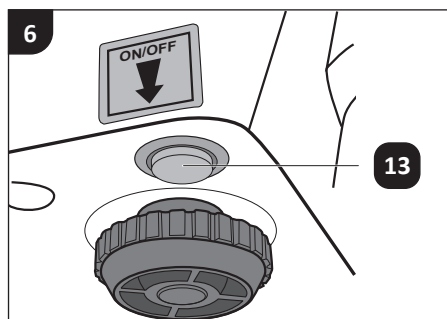

1. Ensure there are no items on the weighing platform.
2. To switch on the scale, briefly press and hold the On/Off button **13**.
The scale switches on and pushes out a label.
3. Remove the label from the label dispenser.
The scale will start beeping if the label is not removed.

You will then be taken to the login area.

Switching off

1. To switch off the scale, press and hold the On/Off button **13** for a few seconds.
A message 'Switch off appliance?' appears in the display.
2. Press 'Switch off'.
The scale is now switched off.

Stand-by mode

1. To switch to stand-by mode, briefly press the On/Off button **13**.
The display turns off and the scale is in stand-by mode.
2. To switch back to normal mode, either briefly press the On/Off button or touch the display.

Connecting the scale to a network

Connecting via Wi-Fi

1. Switch on the scale.



2. Press the 'Operator' button and select 'Admin'.
3. Enter the password '1234'.
4. Press 'Login'.

8

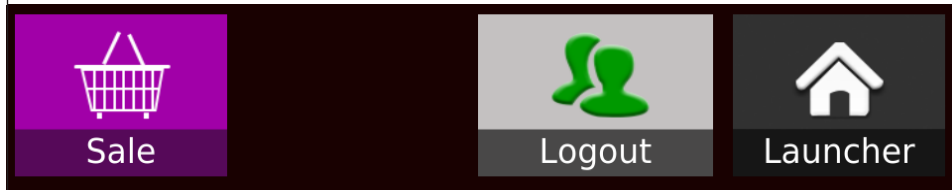

5. Press the 'Launcher' button.

9

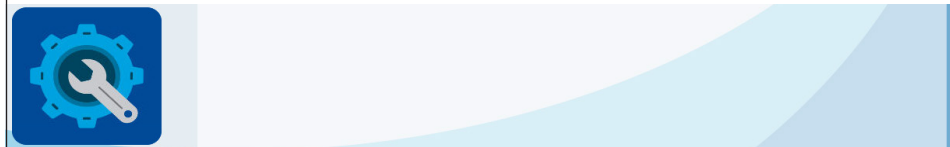

6. Press the button with the setting symbol.

10

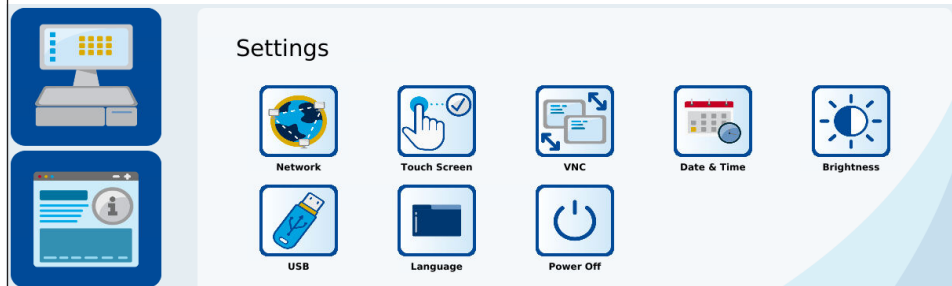

7. Press the 'Network' button.

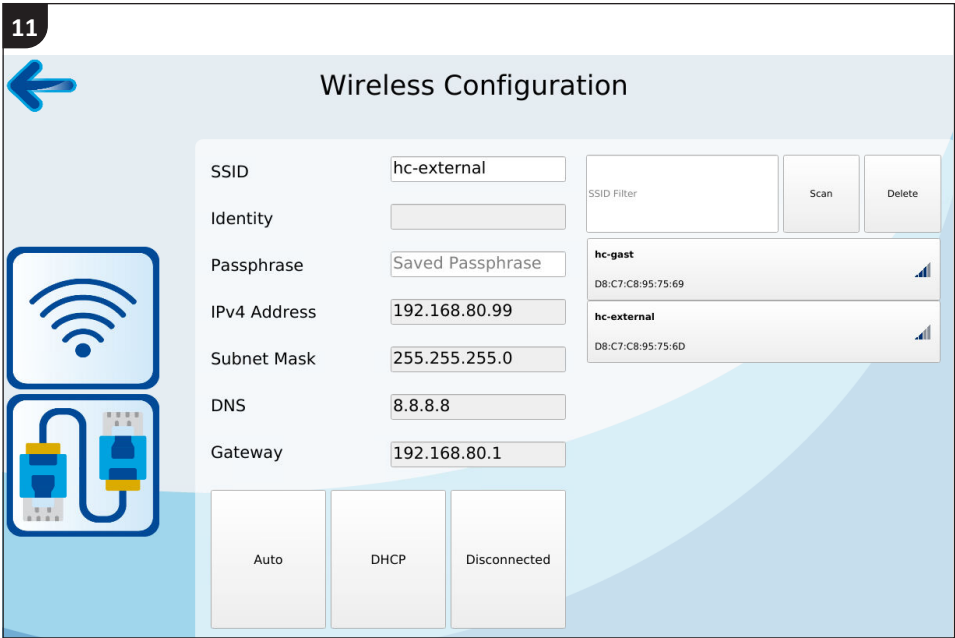

- 8. Press the button with the radio symbol.
- 9. Select your Wi-Fi network from the list and enter the password if necessary.
- 10. Press 'Disconnected' to confirm the entry.
- 11. Press the 'Back' button.

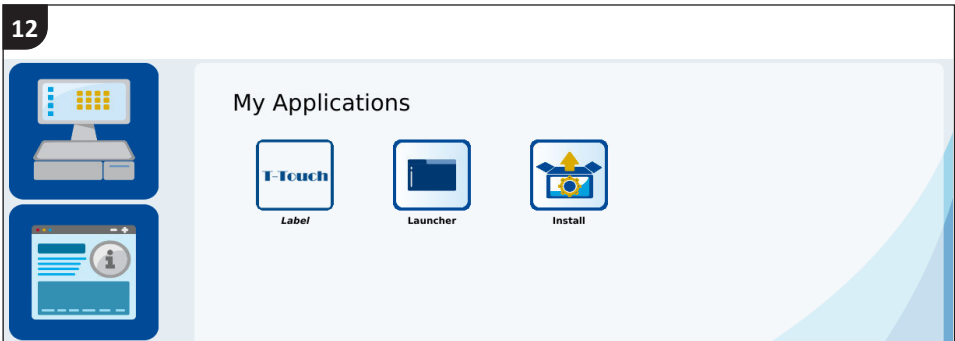

- 12. Press the button with the scale symbol.
- 13. Press the 'Label' button.

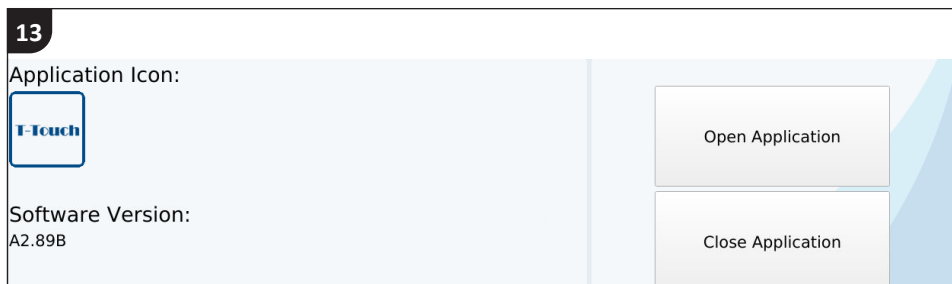

14. Press the 'Close Application' button and then the 'Open Application' button. The set-up is complete, and you can log in again.

Connecting via LAN cable

1. Log in as an Admin in the same way.

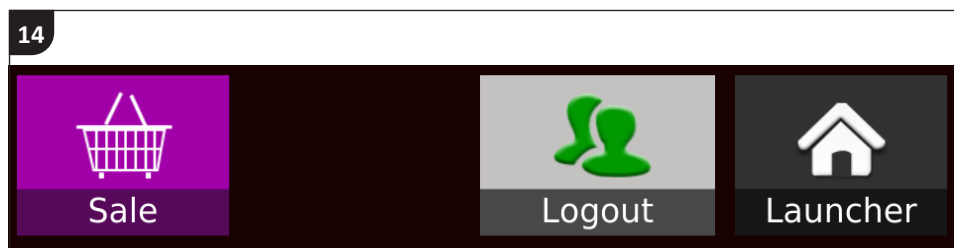

2. Press the 'Launcher' button.

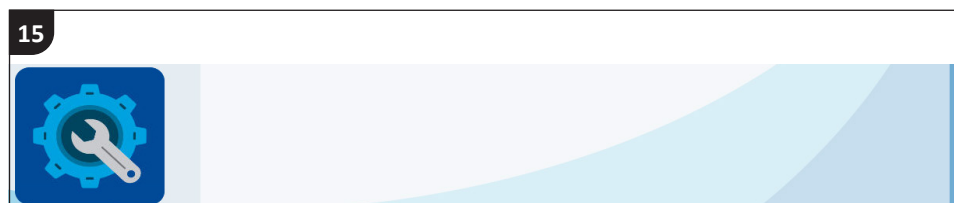

3. Press the button with the setting symbol.

16

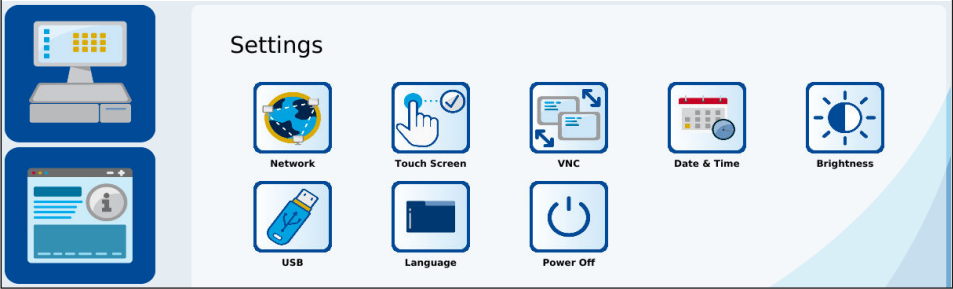

4. Press the 'Network' button.

17

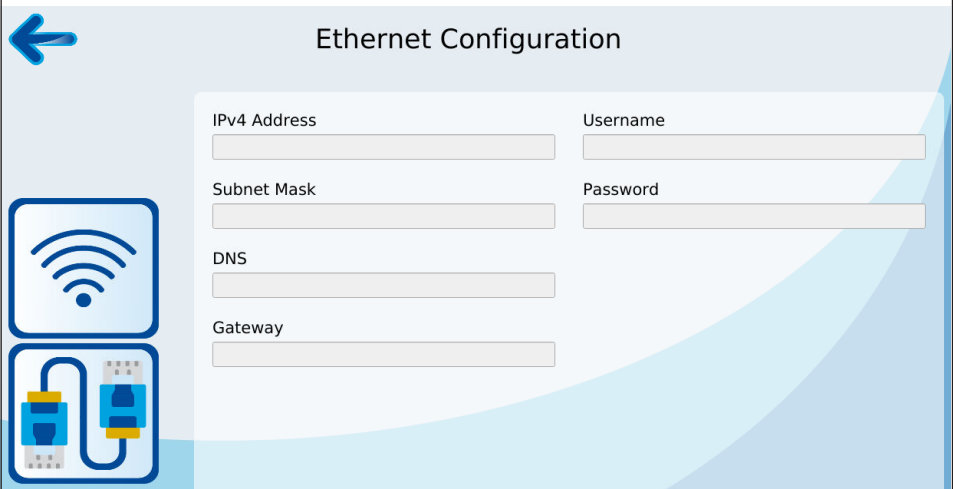

5. Press the button with the LAN cable symbol.

6. Press 'Disconnected' to confirm the entry.

7. Press 'Back'.

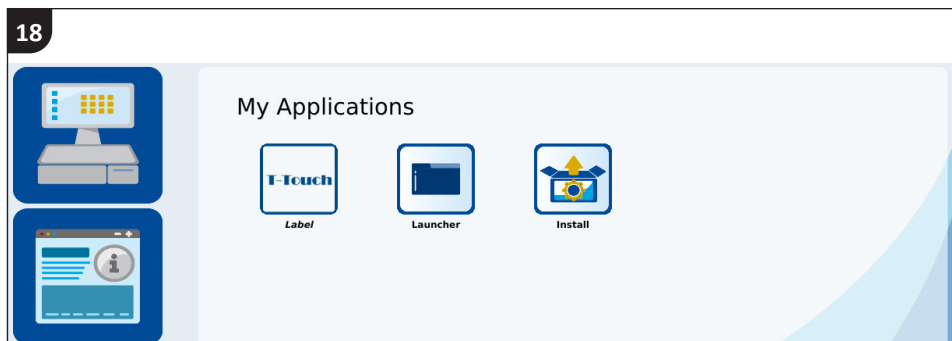

8. Press the button with the scale symbol.

9. Press the 'Label' button.

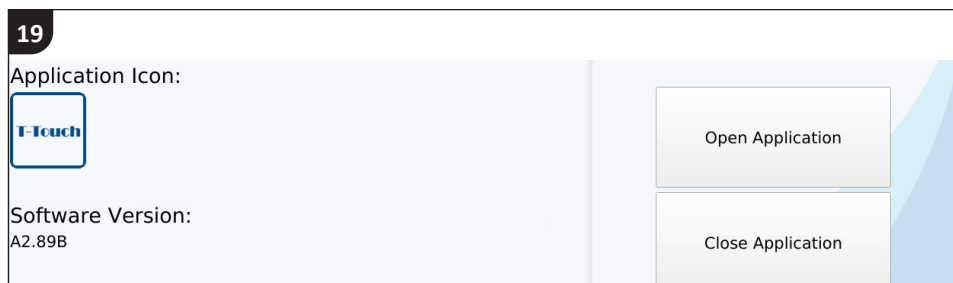

10. Press the 'Close Application' button and then the 'Open Application' button.
The set-up is complete, and you can log in again.

Connecting the scale to the computer

A Windows PC is required to set up the scale.

1. Connect the scale and your PC with a LAN cable or via the Wi-Fi connection that has been set up.
2. Download the operating software from the homepage using the following link or QR code:
ade-germany.de/downloads/software/EWD100PC
3. Unpack the software into a folder.
4. Run the 'T-Touch Central' exe file.

You are now in the login area.



Carrying out the basic configuration using PC software

20

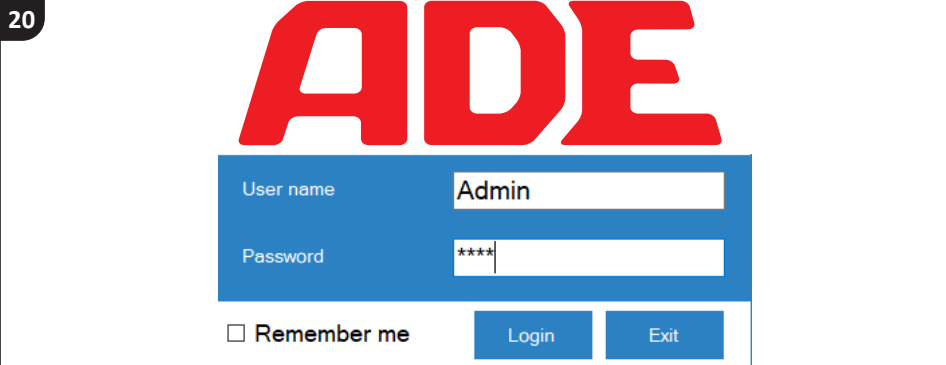

User name Admin

Password ****

Remember me

Login Exit

1. Log in as Administrator by entering 'Admin' as the username and '1234' as the password.

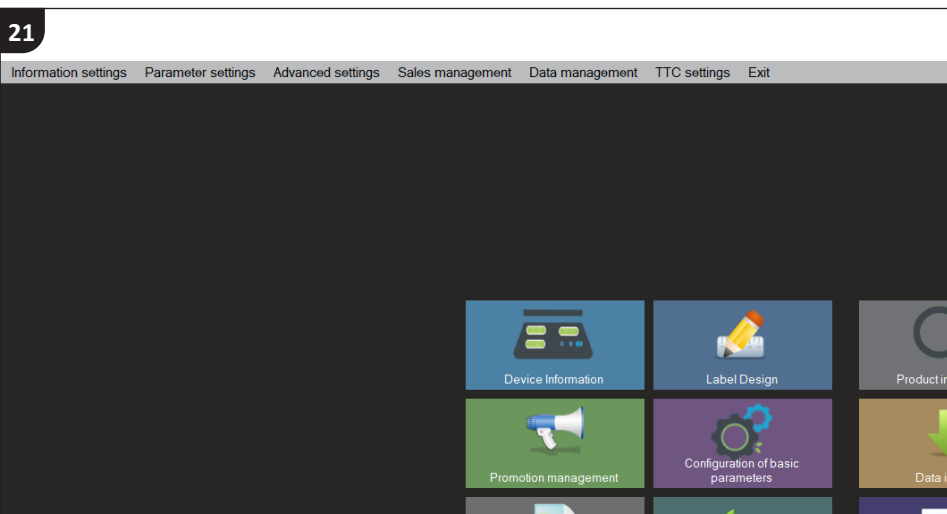

2. Press the 'Device information' button.

22

D 1.0

Device Information

Scale Number

Select All Unselect all Deselected

Select	Edit	Delete	Shop No.	Department	Scale Number	Scale Name	IP Address

3. Press the 'Add' button.

23

Device Information

Shop No.

Department

Scale Number

Scale Name

IP Address

Enable

Main screen background color Color Transparency

Scale Type

Screen Saver

Upload Image

Main background picture

Upload Image

4. Type the IP address in the field with the red star.

24

→ 0 ←  eth0:192.168.35.197

The IP address of the scale is shown in the top red line of the display **9**.

5. Press the 'Save' button.



If you are unable to connect your PC to the device, check that the IP address displayed on the device matches the IP address in the PC software and change it if necessary.

25

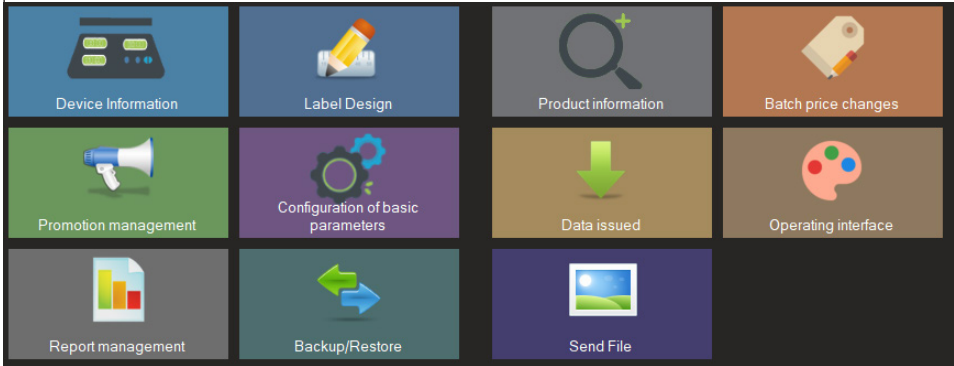

6. Press the button 'Configuration of basic parameters'.

26

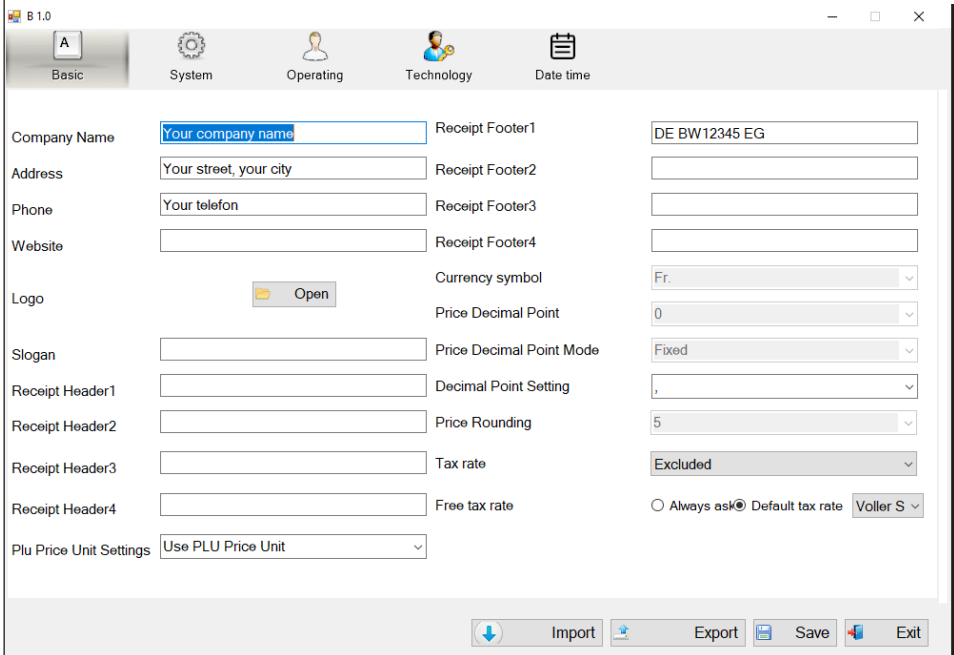

7. Make entries in the mandatory fields: Company name, address and phone.
8. Press the 'Save' button.
9. Close the programme by pressing the 'Exit' tab in the menu bar.

Creating categories and products

Logging in

27



User name

Password

Remember me

Login Exit

- Log in as user by entering 'User' as the username and '1234' as the password.

Creating categories

1. Press the 'Product & Category' tab in the menu bar.

28

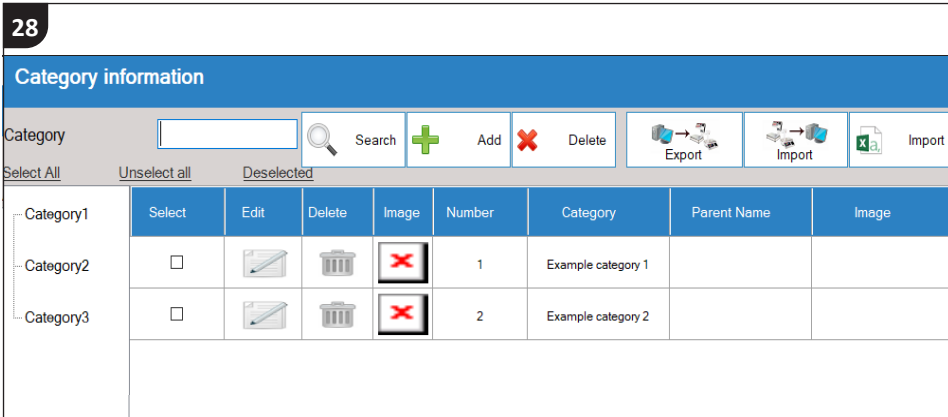

Category information

Category

Search Add Delete

Export Import Import

Select All Unselect all Deselected

	Select	Edit	Delete	Image	Number	Category	Parent Name	Image
Category1								
Category2	<input type="checkbox"/>				1	Example category 1		
Category3	<input type="checkbox"/>				2	Example category 2		

2. Press the 'Add' button.

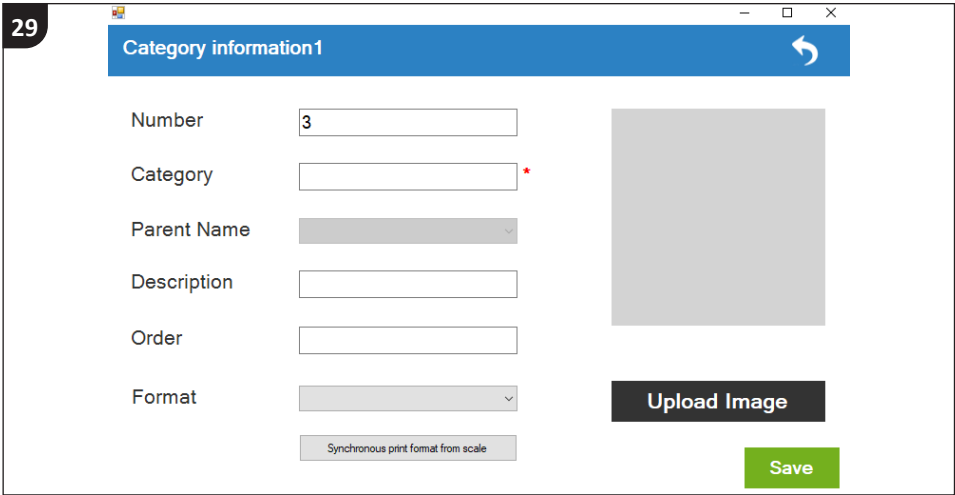

3. Enter a number (e.g. 1) in the 'Number' field.



Numbers from 1–15 are shown on the first page and numbers from 16–32 are shown on the second page of the scale display.

- 4. Enter the category name (e.g. bread or chocolates) in the 'Category' field.
- 5. Press the 'Save' button and close the window.
- 6. If necessary, add more categories in the same way.

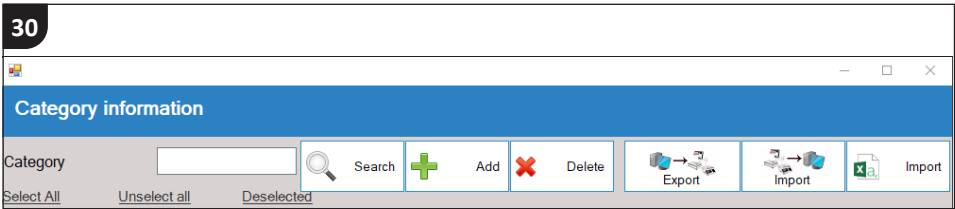

- 7. Press the 'Select All' button.
- 8. Press the 'Export' button.

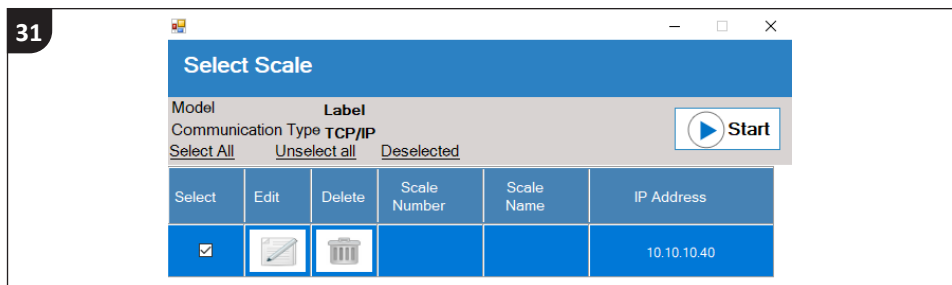

9. Select the scale to which you want to export the data.

10. Press the 'Start' button.

The products have now been exported to the scale.

Creating products

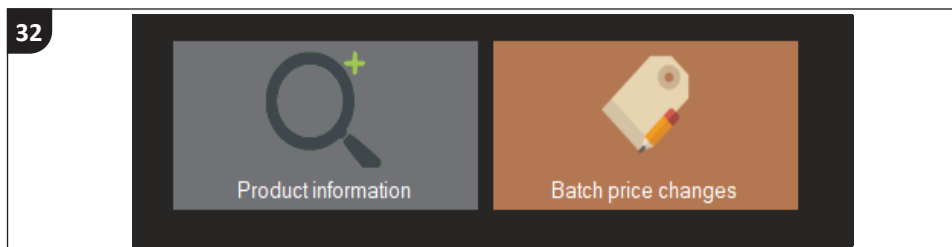

1. Press the 'Product information' button.

You will see a list of sample products that have already been created.

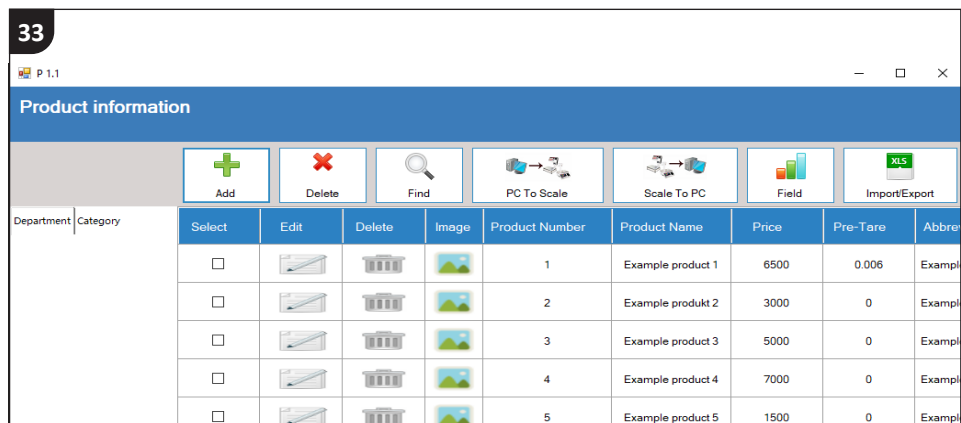

2. Press the 'Add' button.

The product information window opens.

Basic Information

34 Product information 

Product Number Product Name

Basic Information **Attributes** Product manual Note Nutrition

Product Number Product Code



Product Name * Abbreviation

Price * Sales Price

Price Unit Pre-Tare

Tax Category

Department Trademark

 **Upload** 

Save

1. Enter the PLU (product number), product name and price.
2. Select the price unit.
3. Enter the tax.
4. If necessary, enter a pre-tare (e.g. packaging weight).
5. Select the category to which the product is to be assigned.

Further information

35

Product information

Product Number Product Name

Basic Information | Attributes | Product manual | Note | Nutrition

Disabled BarCode Format

Trace Shelf Number

Label Format Label Format2

Production Date FOLLOW

Packing date

Use By date

Save

1. Select a 'label format'.
2. If necessary, select an additional label via 'Label Format2'.



An overview of the label formats can be found on Page 39.

3. Select 'Print Date (+/-)' in the 'Use By date' line and enter the number of days, indicating the minimum shelf life of the goods from label printing.
4. Enter a BarCode Format if necessary.



If a barcode is to be used, the barcode number must be entered in the 'Basic Information' window under 'Product Code'.

The barcode EAN13_Full requires a 13-digit product ID.

The barcode EAN13_Quantity/Price requires a 5-digit product ID.

Text boxes

36
Product information
↶

Product Number

Product Name

Basic Information
Attributes
Product manual
Note
Nutrition

Nutritional value	<input style="width: 100%;" type="text"/>	Ingredient	<input style="width: 95%; height: 25px;" type="text" value="Ingredients come here"/> B
Produced	<input style="width: 100%;" type="text"/>	Origin	<input style="width: 100%;" type="text"/>
Expiration Period	<input style="width: 100%;" type="text"/>	Temperature range	<input style="width: 100%;" type="text"/>
Recommend Period	<input style="width: 100%;" type="text"/>		

Save

1. Enter the ingredients in the 'Ingredient' field.
2. Format allergens in bold by highlighting the ingredient with the mouse and pressing the 'B' next to the text box.



The allergenic ingredients, which must be labelled in accordance with the Food Information Regulation (EU) No. 1169/2011, must be highlighted in pre-packaged goods, for example, through the font, the font style or the background colour, and must thus be clearly distinguished from the rest of the list of ingredients.

Notes

37

Product information
⏪

Product Number

Product Name

Basic Information Attributes Product manual Note Nutrition

Note1	<input style="width: 100%; height: 20px;" type="text" value="Additional note here"/>	Note2	<input style="width: 100%; height: 20px;" type="text" value="Long Additional note 2 here"/>
Note3	<input style="width: 100%; height: 20px;" type="text"/>	Note4	<input style="width: 100%; height: 20px;" type="text"/>
Note5	<input style="width: 100%; height: 20px;" type="text"/>	Note6	<input style="width: 100%; height: 20px;" type="text"/>
Note7	<input style="width: 100%; height: 20px;" type="text"/>	Note8	<input style="width: 100%; height: 20px;" type="text"/>

1. Enter a text in the 'Note1' field.
This text is only displayed on the label in one line with max. 40 characters.
2. If you have selected the additional label 'Z58-4', enter a text in the field 'Note2'.
This text is displayed on the label in up to 18 lines with a maximum of 800 characters.

Nutritional values

38

Product information

Product Number Product Name

Basic Information | Attributes | Product manual | Note | Nutrition

Nutrition Facts

Serving per container

Serving size

Calories zinc

Total fat copper

Saturated fat

Trans fat Vitamin b1

cholesterol Vitamin b2

sodium Vitamin b3

Total carbohydrate Vitamin b5

Dietary fiber Vitamin b6

Total sugars Vitamin b7

Added sugars Vitamin b9

Save



According to the Food Information Regulation (EU) No. 1169/2011, the following nutritional information (based on 100 grams or 100 millilitres) must be provided:

- Energy content (in kcal or kJ)
- Fat
- Sat. fat
- Salt
- Carbohydrates
- Sugar
- Protein

1. Enter the values in the text boxes.
2. Press the 'Save' button to finish.

Exporting data to the scale

You can export categories and products to the scale.

39

T-Touch Central (V1.13.88) - User(User)

















Information settings Advanced settings Sales management Data management TTC settings Exit

1. Select 'Information settings' in the menu bar.
2. Select 'Product information' or 'Category information'.

Alternatively, you can also call up the products directly using the 'products' button.

40









Product information

		 Add	 Delete	 Find	 PC To Scale	 Scale To PC	 Field	 Import/Export		
Department	Category	Select	Edit	Delete	Image	Product Number	Product Name	Price	Pre-Tare	Abbrev
		<input type="checkbox"/>				1	Example product 1	6500	0.006	Example
		<input type="checkbox"/>				2	Example produkt 2	3000	0	Example
		<input type="checkbox"/>				3	Example product 3	5000	0	Example

Select All Unselect all Deselected

41

Category information

Category		 Search	 Add	 Delete	 Export	 Import	 Import	
Select All	Unselect all	Deselected						
Category	Select	Edit	Delete	Image	Number	Category	Parent Name	Image
Category1								
Category2	<input type="checkbox"/>				1	Example category 1		
Kategorie2								

3. Press the 'Select All' button.
4. Press the 'Export' or 'PC to scale' button.

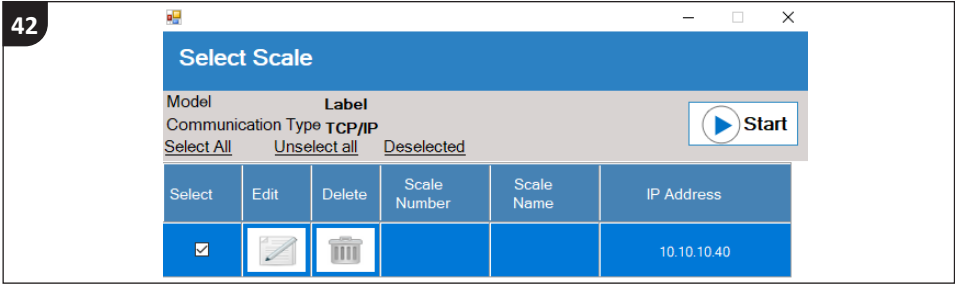

- 5. Select the scale to which you want to export the data.
- 6. Press the 'Start' button.



The 'Import' or 'Scale to PC' button can be used to import categories and products stored on the scale to the computer. This option can be useful if you are using a new computer and want to transfer the values from the scale to it.

Changing the price

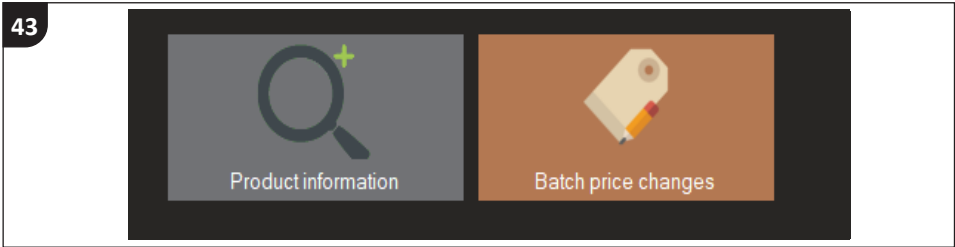

- 1. Press the 'Batch price changes' button.

44

The screenshot shows a software window titled 'B 1.0'. On the left is a table with the following data:

Select	ID	Product Number	Product Name	Price	Sales Price
<input type="checkbox"/>	10679	1	Example product 1	6500	6500
<input type="checkbox"/>	10680	2	Example produkt 2	3000	3000
<input type="checkbox"/>	10681	3	Example product 3	5000	5000
<input type="checkbox"/>	10682	4	Example product 4	7000	7000
<input type="checkbox"/>	10683	5	Example product 5	1500	

On the right side of the window is a sidebar with the following controls:

- Column name: Product Nur (dropdown)
- Content: [input field]
- Find: [magnifying glass icon]
- Select All
- Unselect all
- Deselected
- Save: [floppy disk icon]
- Export: [downward arrow icon]
- Exit: [door icon]

2. Change the price of the desired product by pressing directly on the value in the 'Price' column and entering a new value there.
3. Press the 'Save' button.
4. Press the 'Select All' button.
5. Press the 'Export' button.
6. Select the scale to which you want to export the data.
7. Press the 'Start' button.

Operation

Login

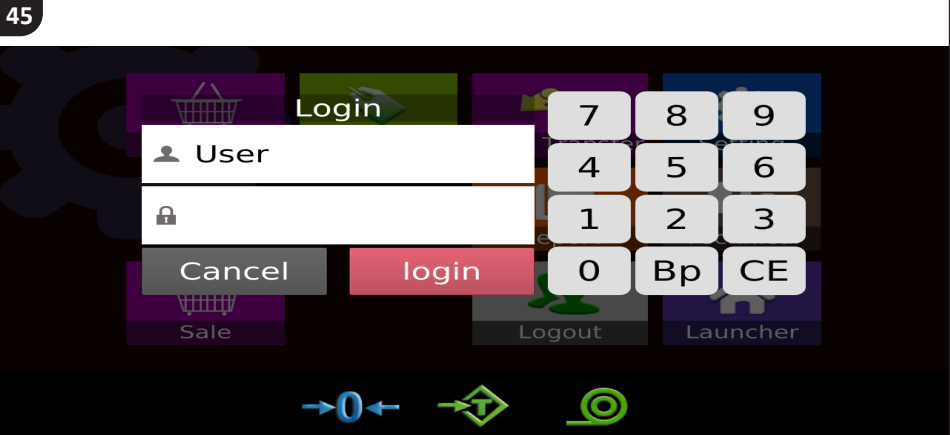

1. Log in as 'User'.



2. Press 'Sale'.

Weighing items

47

Tare	kg	Weight	kg	Unit Price	\$/kg	Price	\$
0.000		0.000		0.00		0.00	

Tare

Set zero

Categories

Auto label
on / off

Label

Example category 1

Example category 2

Ostern

Lebkuchen

Verschiedene Etiketten

1. Select a product category.

48

Tare	kg	Weight	kg	Unit Price	\$/kg	Price	\$
0.000		0.000		8.50		0.00	00001
							Example product 1

Tare

Set zero

Products

Auto label
on / off

Label

Example product
3
00003

Example product
4
00004

Example product
5
00005

2. Select a product.
3. Press 'Label'.
The label is printed.

Setting Auto label

You can set automatic printing via the 'Auto label On/Off' button. The label is then printed as soon as you place an item on the weighing platform and the weight stabilises.

Using the tare function

The tare function is designed to determine the difference between the gross or total weight and the net weight of an item.

If you did not define a pre-tare on the computer when you created the product, you can use this function to define a tare value for the packaging.

Normal tare

1. Place an item on the weighing platform.

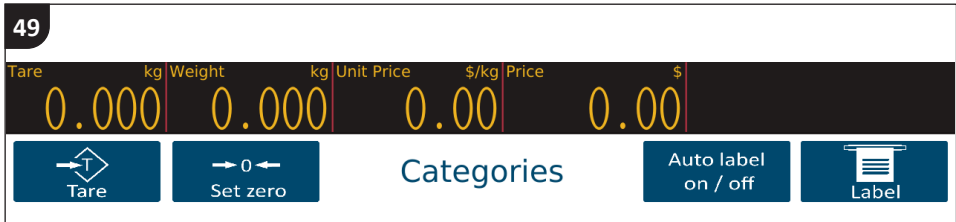

2. Press the 'Tare' button.

The tare value is shown in the 'Tare' display. When you remove the item from the weighing platform, the 'Weight' display shows the negative tare value.

3. To delete the tare value, press the 'Set zero' button.

Manual tare input

1. If you want to manually enter a specific weight as a tare value, make sure that the weighing platform is empty.
2. Press the 'Tare' button.

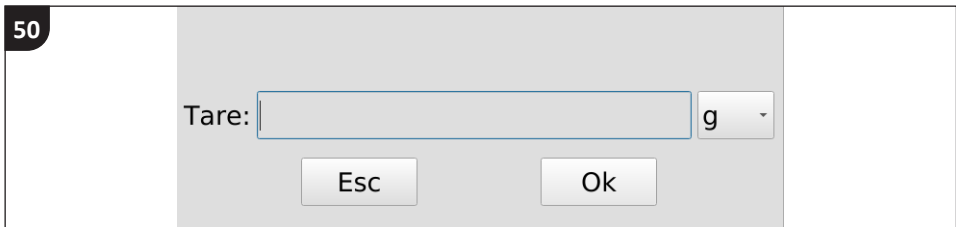

3. Enter the tare value and select the weight unit.
4. Confirm the entry with 'OK'.

The tare value is shown in the 'Tare' display.

Label formats

Standard labels 58×60 mm – Main labels

51

H58-1

Your company name
Your street, your city
Your telefon

Example product 1

Best before: 17-09-2023
Additional note here

kg	\$/kg	\$
0,184	12,80	2,36



218000001001841

- Company, address, telephone, email
- Product name, 2 rows, ca. 40 characters
- BBD
- Note 1, 1 row, ca. 45 characters
- Weight, price per quantity, price
- Barcode EAN13 price-coded

H58-2

Your company name
Your street, your city
Your telefon

Example product 1

Best before: 17-09-2023
Additional note here

kg
0,184



218000001001841

- Company, address, telephone, email
- Product name, 2 rows, ca. 40 characters
- BBD
- Note 1, 1 row, ca. 45 characters
- Weight
- Barcode EAN13 weight-coded

H58-3

Your company name
Your street, your city
Your telefon

Example product 1

Ingredients
Ingredients come here

Best before: 17-09-2023
Additional note here

kg	\$/kg	\$
0,184	12,80	2,36



218000001001841

- Company, address, telephone, email
- Product name, 2 rows, ca. 40 characters
- Ingredients, 4 rows, ca. 175 characters
- BBD
- Note 1, 1 row, ca. 45 characters
- Weight, price per quantity, price
- Barcode EAN13 price-coded

H58-4

Your company name
Your street, your city
Your telefon

Example product 1

Ingredients
Ingredients come here

Best before: 17-09-2023
Additional note here

kg
0,184



218000001001841

- Company, address, telephone, email
- Product name, 2 rows, ca. 40 characters
- Ingredients, 4 rows, ca. 175 characters
- BBD
- Note 1, 1 row, ca. 45 characters
- Weight
- Barcode EAN13 weight-coded

H58-5

Your company name
Your street, your city
Your telefon

Example product 1

Ingredients
Ingredients come here

Best before: 17-09-2023
Additional note here

kg	\$/kg	\$
0,184	12,80	2,36

- Company, address, telephone, email
- Product name, 2 rows, ca. 40 characters
- Ingredients, 8 rows, ca. 350 characters
- BBD
- Note 1, 1 row, ca. 45 characters
- Weight, price per quantity, price

H58-6

Your company name
Your street, your city
Your telefon

Example product 1

Ingredients
Ingredients come here

Best before: 17-09-2023
Additional note here

0,184 kg

- Company, address, telephone, email
- Product name, 2 rows, ca. 40 characters
- Ingredients, 8 rows, ca. 350 characters
- BBD
- Note 1, 1 row, ca. 45 characters
- Weight

Standard labels 58×60 mm – Additional labels

52

ENGLISH

Z58-1

Example product 1
Ingredients
 Ingredients come here

- Product name, 1 row, ca. 40 characters
- Ingredients, 18 rows, ca. 800 characters

Z58-2

Example product 1

Nutritional values 100g

Energy	0	/	kcal/J
Fat	0		g
o.w. saturates	0		g
Carbohydrate	0		g
of which sugars	0		g
Protein	0		g
Salt	0		g

- Product name, 1 row, ca. 40 characters
- Nutritional table

Z58-3

Example product 1
Ingredients
 Ingredients come here

Nutritional values 100g

Energy	0	/	kcal/J
Fat	0		g
o.w. saturates	0		g
Carbohydrate	0		g
of which sugars	0		g
Protein	0		g
Salt	0		g

- Product name, 1 row, ca. 40 characters
- Ingredients, 9 rows, ca. 400 characters
- Nutritional table

Z58-4

Example product 1
 Long Additional note 2 here

- Product name, 1 row, ca. 40 characters
- Note 2, 18 rows, ca. 800 characters

Standard labels 58×76 mm – Main labels

53

H76-1

Your company name
Your street, your city
Your telefon

Example product 1

Ingredients
Ingredients come here

Best before: 17-09-2023
Additional note here

kg	\$/kg	\$
0,184	12,80	2,36

- Company, address, telephone, email
- Product name, 2 rows, ca. 40 characters
- Ingredients, 13 rows, ca. 575 characters
- BBD
- Note 1, 1 row, ca. 45 characters
- Weight, price per quantity, price

H76-2

Your company name
Your street, your city
Your telefon

Example product 1

Ingredients
Ingredients come here

Best before: 17-09-2023
Additional note here

kg
0,184

- Company, address, telephone, email
- Product name, 2 rows, ca. 40 characters
- Ingredients, 13 rows, ca. 575 characters
- BBD
- Note 1, 1 row, ca. 45 characters
- Weight

H76-3

Your company name
Your street, your city
Your telefon

Example product 1

Ingredients
Ingredients come here

Best before: 17-09-2023
Additional note here

kg	\$/kg	\$
0,184	12,80	2,36



2180000010018411

- Company, address, telephone, email
- Product name, 2 rows, ca. 40 characters
- Ingredients, 9 rows, ca. 400 characters
- BBD
- Note 1, 1 row, ca. 45 characters
- Weight, price per quantity, price
- Barcode EAN13 price-coded

H76-4

Your company name
Your street, your city
Your telefon

Example product 1

Ingredients
Ingredients come here

Best before: 17-09-2023
Additional note here

kg
0,184



2180000010018411

- Company, address, telephone, email
- Product name, 2 rows, ca. 40 characters
- Ingredients, 9 rows, ca. 400 characters
- BBD
- Note 1, 1 row, ca. 45 characters
- Weight
- Barcode EAN13 weight-coded

H76-5

Your company name
Your street, your city
Your telefon

Example product 1

Ingredients
Ingredients come here

Nutritional values 100g

Energy	0	/	kcal/J
Fat	0	g	
o.w. saturates	0	g	
Carbohydrate	0	g	
of with sugars	0	g	
Protein	0	g	
Salt	0	g	

Best before: 17-09-2023
Additional note here

kg	\$/kg	\$
0,184	12,80	2,36

- Company, address, telephone, email
- Product name, 2 rows, ca. 40 characters
- Ingredients, 4 rows, ca. 175 characters
- Nutritional table
- BBD
- Note 1, 1 row, ca. 45 characters
- Weight, price per quantity, price

H76-6

Your company name
Your street, your city
Your telefon

Example product 1

Zutaten
Ingredients come here

Durchschnittliche Nährwerte pro

Energie	0	/	kcal/J
Fett	0	g	
davon ges.	0	g	
Kohlenhydrate	0	g	
davon Zucker	0	g	
Eiweiß	0	g	
Salz	0	g	

Mindestens haltbar bis: 17-09-2023
Additional note here

kg
0,184

- Company, address, telephone, email
- Product name, 2 rows, ca. 40 characters
- Ingredients, 4 rows, ca. 175 characters
- Nutritional table
- BBD
- Note 1, 1 row, ca. 45 characters
- Weight

Standard labels 58×76 mm – Additional label

54

Z76-1

Example product 1

Nutritional values 100g

	0	1	kcal/lj
Energy	0		
Fat	0		g
o.w. saturates	0		g
Carbohydrate	0		g
of which sugars	0		g
Protein	0		g
Salt	0		g

Long Additional note 2 here

- Company, address, telephone, email
- Product name, 1 row, ca. 40 characters
- Nutritional table
- Note 2, 11 rows, ca. 440 characters

ENGLISH

Troubleshooting

Problem	Possible causes	Solution
Scale is beeping.	A label is still stuck in the label output.	Take out the label.
The scale does not work.	The AC adapter is not connected.	Plug the AC adapter into a power outlet.
	The scale is not switched on.	Switch on the scale.
The display is blank.	The scale has switched off.	Switch on the scale again.
The weight display is not stable.	There is a draught.	Close open windows or relocate the scale.
	The scale is exposed to vibrations.	Avoid vibrations or relocate the scale.
	The scale is disturbed by electromagnetic fields from other equipment or static charges.	Turn off the equipment near the scale or relocate the scale.
The weighing result is clearly wrong.	The scale is not set up correctly.	Set the scale up correctly, as described in chapter "First use".
	The scale is exposed to temperature conditions that are outside the permissible range.	Only operate the scale within the permissible temperature conditions.
	The scale is disturbed by electromagnetic fields from other equipment or static charges.	Turn off the equipment near the scale or relocate the scale.
The error message '--oL--' is displayed.	The zero setting range or the maximum weighing capacity has been exceeded.	Remove the item from the scale.

Problem	Possible causes	Solution
The error message "--UL--" is displayed.	The zero setting range or the maximum weighing capacity has been exceeded.	Make sure that the load plate is correctly positioned. Then switch the scale off and on again if necessary.

Cleaning and maintenance



WARNING!

Risk of electric shock!

Careless handling of the appliance during cleaning or maintenance may cause electric shock.

- Disconnect the mains plug from the socket before carrying out cleaning or maintenance work.



NOTICE!

Risk of short circuit!

Water or other liquids that have penetrated the housing may cause a short circuit.

- Never immerse the scale in water or other liquids.
- Make sure that no water or any other liquids get into the housing.



NOTICE!

Risk of damage!

Improper handling of the scale may cause damage to it.

- Do not use any aggressive cleaners, brushes with metal or nylon bristles, or sharp or metallic cleaning utensils such as knives, hard scrapers, etc. They could damage the surfaces.

- Do not put the scale in a dishwasher. It would be destroyed as a result.
- 1. To disconnect the scale **1** from the mains, pull the mains plug **3** out of the socket.
- 2. Carefully remove the weighing platform.
- 3. Use a slightly damp cloth or commercially available mild disinfectant to clean all surfaces.
- 4. Let all parts dry completely.
- 5. Place the weighing platform back on the scale.

Transport

1. Switch off the scale **1**.
2. Disconnect the mains plug **3** from the socket.
3. Use the original packaging for the scale and the AC adapter. Use the packaging material so that the scale is protected and secured in the packaging during transport.

Storage

All parts must be completely dry before being stored.

- Always store the scale in a dry place.
- Protect the scale from direct sunlight.
- Do not store the scale in an upright position.
- The scale must be stored in a securely closed, dry and frost-free place unreachable for children at a temperature between +5 °C and +40 °C.

Spare parts

Name	Article number
Label cassette	H2336-001

Technical specifications

Scale

Model:	EWD100-6	EWD100-15
Maximum weighing capacity:	6 kg	15 kg
Minimum weighing capacity:	20 g	40 g
Digit increment:	1 g < 3 kg > 2 g	2 g < 6 kg > 5 g

Supply voltage:	100–240 V~; 50/60 Hz
Dimensions:	400 × 520 × 600 mm
Weighing platform:	380 × 272 mm (stainless steel)
Weight:	8.7 kg
Operating temperature range:	-10 °C to +40 °C

Disposal

Disposing of the packaging



Dispose of the packaging separated into single type materials. Dispose of paperboard and cardboard with waste paper and plastics with recyclable waste.

Disposing of the appliance

(Applicable in the European Union and other European states with systems for the separate collection of reusable waste materials)



Old devices must not be disposed of with household waste!

If the product can no longer be used, all users are **required by law to dispose of the device separately from household waste**, e.g. at a collection point in their community/borough. This ensures that old devices are recycled properly and rules out any negative impact on the environment. For this reason, electrical equipment is marked with the symbol shown here.

Declaration of Conformity



Appliances bearing the CE mark meet all applicable Community regulations for the European Economic Area.

The EU declaration of conformity can be requested from the address specified on the back of the user manual.



Declaration of Conformity (see chapter “Declaration of conformity”): Products labelled with this symbol meet all applicable provisions of the United Kingdom.

Warranty

ADE Germany GmbH will repair or replace this product provided proof is furnished that damage caused by defects in materials and workmanship occurred within one year from the date of purchase. Proof of purchase is required.

The warranty does not apply to all moving parts, such as rechargeable batteries or cables. Using accessories other than those approved by ADE Germany GmbH will render the warranty null and void. This applies in particular to the use of non-approved rechargeable batteries.

The warranty does not cover items damaged by normal wear and tear or damage caused by accident or misuse. The warranty does not cover appliances that have been tampered by unauthorised persons. This agreement does not invalidate the customer's statutory rights.

For any complaints, customer service or provision of spare parts, please contact the dealer from whom you purchased the scale.

CUSTOMER SERVICE



+49 40 432776-0

At the regular land line rate of your phone company



info@ade-germany.de

ade-germany.de

© Copyright

Reprint or reproduction (including extracts)

only with the approval of:

ADE Germany GmbH
Neuer Höltigbaum 15
22143 Hamburg
Germany

2023

Distributed by:

ADE Germany GmbH
Neuer Höltigbaum 15
22143 Hamburg
Germany
ade-germany.de